

DISASSEMBLY

1. REMOVE SHIFT LEVER KNOB AND SHIFT LEVER KNOB COVER

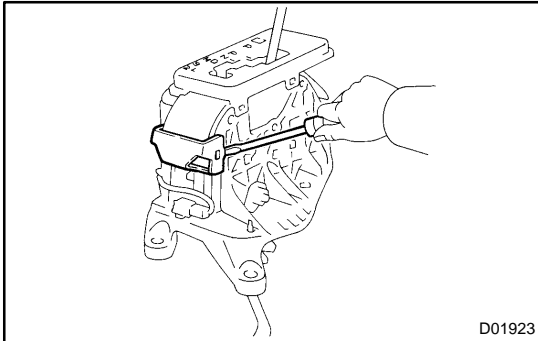

2. REMOVE WIRE PROTECTOR

Using a screwdriver, remove the wire protector.

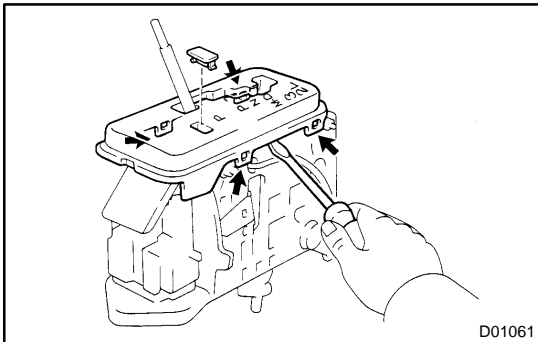

3. REMOVE POSITION INDICATOR HOUSING

- (a) Using a screwdriver, remove the position indicator housing.
- (b) Using a screwdriver, remove the shift lever cap from the position indicator housing.

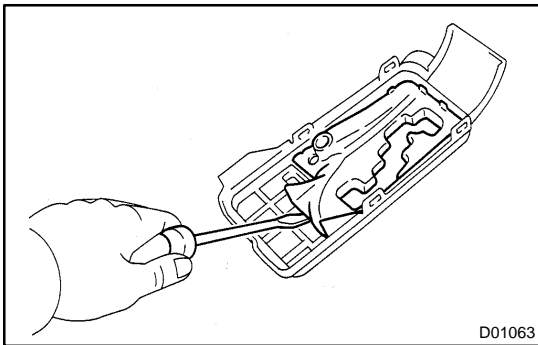

4. REMOVE POSITION INDICATOR LENS

Using a screwdriver, remove the position indicator lens from the position indicator housing.

5. REMOVE SLIDE COVER

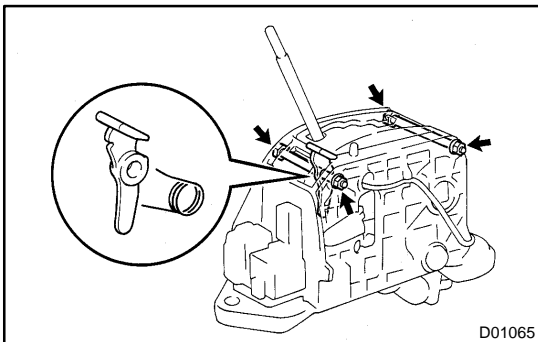

6. REMOVE SHIFT LOCK RELEASE LINK AND SPRING

- (a) Remove the 2 shift lever housing set bolts and nuts with the shift lock release link and spring.
- (b) Using a screwdriver, separate the shift lock release spring from the shift lock release link.

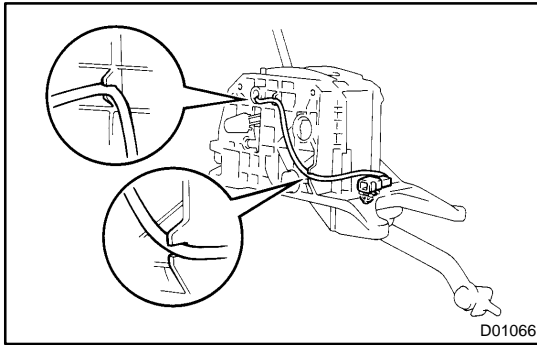

7. REMOVE SHIFT LEVER GUIDE HOUSING AND INDICATOR LAMP SUB-ASSEMBLY

- (a) Disconnect the indicator lamp wire and connector from the shift lever plate.

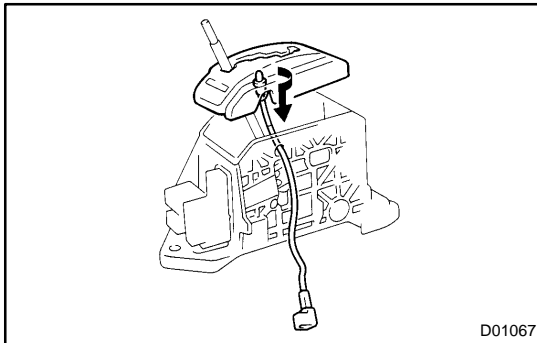

- (b) Remove the shift lever guide housing with the indicator lamp sub-assembly from the shift lever plate.
- (c) Remove the indicator lamp sub-assembly from the shift lever guide housing.

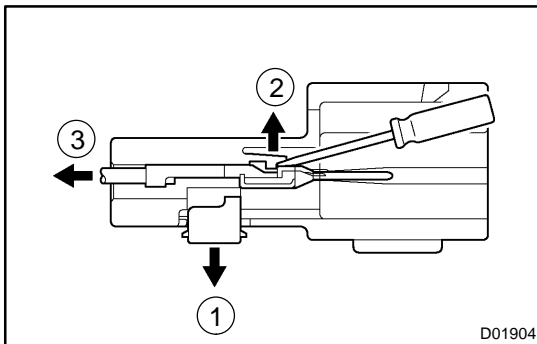

8. DISASSEMBLE INDICATOR LAMP SUB-ASSEMBLY

- (a) Remove the bulb from the indicator lamp wire sub-assembly.
- (b) Using a small screwdriver, remove the terminals of the indicator lamp wire sub-assembly from the connector, as shown in the illustration.

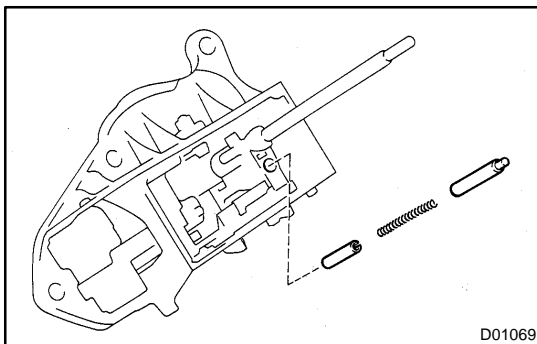

9. REMOVE SHIFT LEVER DETENT PIN, SHIFT LEVER SPRING DAMPER AND COMPRESSION SPRING FROM SHIFT LEVER SUB-ASSEMBLY

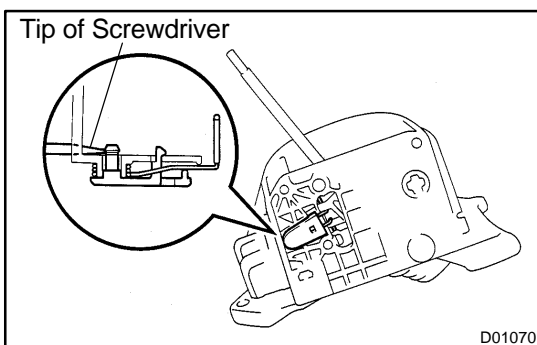

10. REMOVE SPRING HOLDER AND SHIFT LEVER TORSION SPRING

- (a) Using a screwdriver, remove the spring holder.

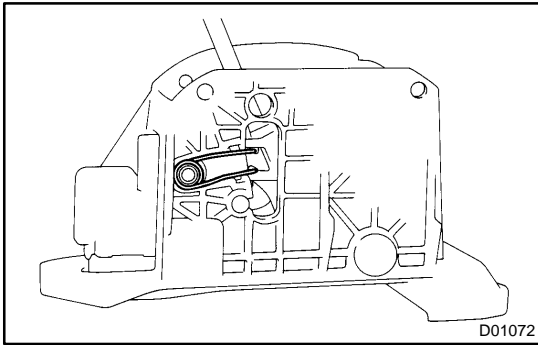

- (b) Remove the shift lever torsion spring.

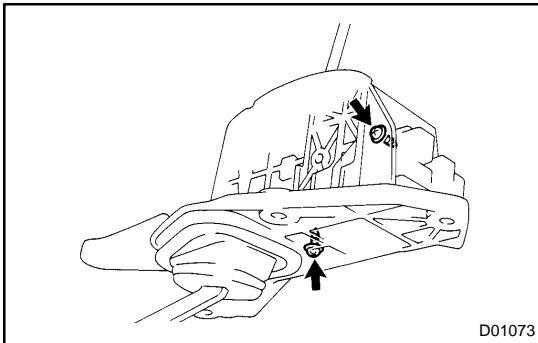

11. REMOVE 2 SHIFT LOCK CONTROL UNIT ASSEMBLY SET SCREWS

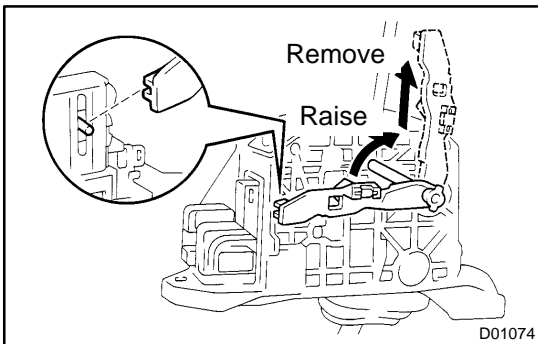

12. REMOVE NO.1 SHIFT LOCK SWITCH PLATE

- (a) Disconnect the groove of the No.1 shift lock switch plate from the projection of the shift lock control unit.
(b) Raise the plate up to the direction shown in the illustration.
(c) Remove the plate.

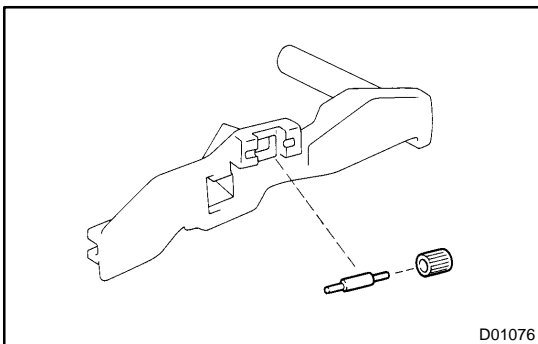

- (d) Remove the roller and shift lever anti-rattle cushion from the plate.
(e) Separate the shift lever anti-rattle cushion from the roller.

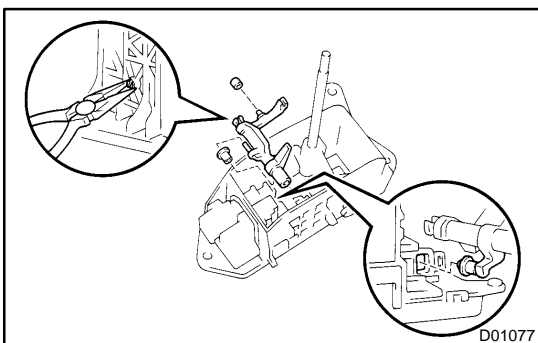

13. REMOVE SHIFT LOCK PLATE STOPPER

- (a) Using pliers, remove the stopper.
(b) Remove the shift lever anti-rattle cushion and shift lock plate stopper cap from the shift lock release stopper.
(c) Remove the shift lock release spring from the shift lock plate stopper.

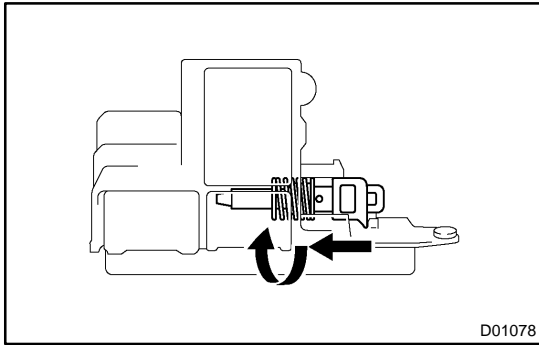

- 14. REMOVE SHIFT LOCK CONTROL UNIT ASSEMBLY**
- Remove the shift lock control unit assembly from the shift lever plate.
 - Push the shift lock solenoid link lightly, turn and remove it.
 - Remove the compression spring.
 - Remove the slotted spring pin and separate the shift lock solenoid link.

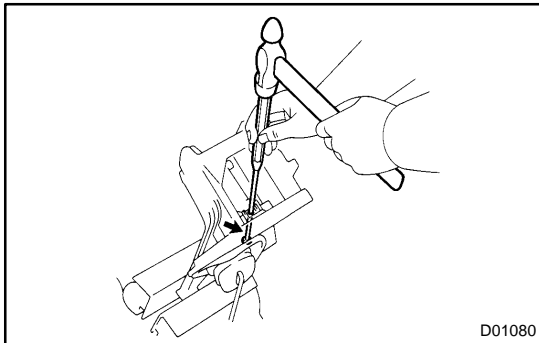

- 15. REMOVE SHIFT LEVER SUB-ASSEMBLY**
- Using a pin punch and hammer, drive out the pin.
 - Remove the shift lever sub-assembly.

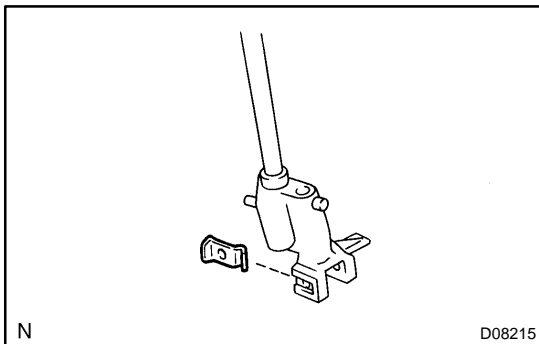

- Remove the shift lever nut from the shift lever sub-assembly.

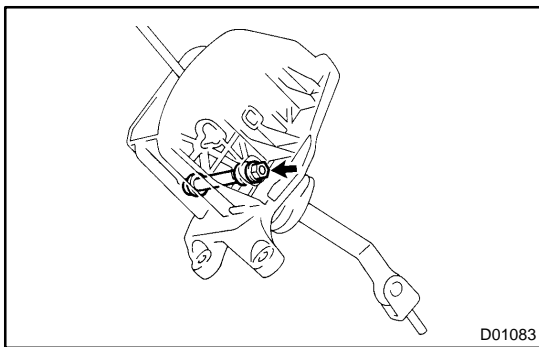

- 16. REMOVE CONTROL LEVER, SPACER AND CONTROL SHAFT**
- Remove the nut.
 - Remove the 2 spacers and control shaft from the shift lever plate.

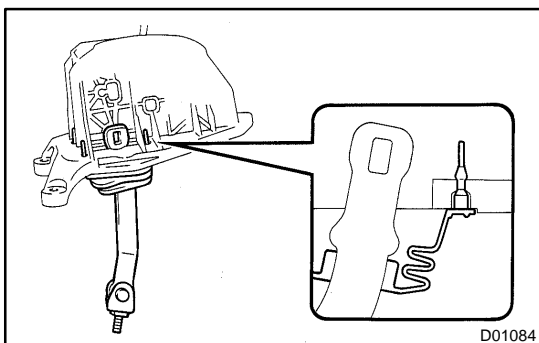

- Disconnect the shift lever boot from shift lever plate.
- Remove the control lever.

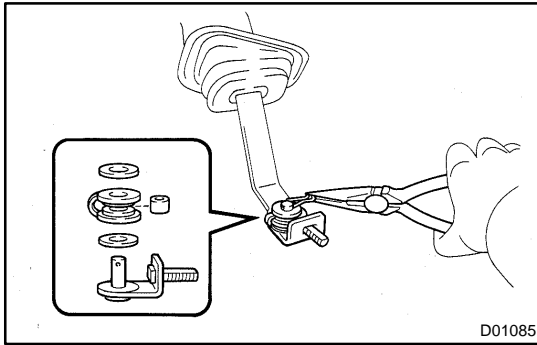

17. REMOVE CLIP, CONNECTING ROD SWIVEL, LOWER CONTROL SHAFT BUSHING, LOWER CONTROL SHAFT PIECE, PLATE WASHER AND SHIFT LEVER BOOT FROM CONTROL LEVER

- (a) Using pliers, remove the clip.
- (b) Remove the connecting rod swivel, lower control shaft bushing, lower control shaft piece, 2 plate washers and shift lever boot from the control lever.